

Modified Admixed Dental Alloy

Description: Alloy for dental amalgam with a modified mix of particles, high-copper content and free of zinc. It is a filling material for class 1 and 2 restorations in molars and premolars.

Composition: 40% Ag - 31% Sn - 29% Cu.

Physical properties:

Compressive strength at 1 hour	> 80 MPa
Compressive strength at 24 hours	> 300 MPa
Creep	< 0.3%
Dimensional change	Minimum
Working time	6-8 minutes (regular set) 5-7 minutes (fast set)

Spill identification: the color of the capsule identifies both the spill size and the hardening type.

Spill	Regular set			Fast set		
	Capsule color	Alloy (g)	Mercury (g)	Capsule color	Alloy (g)	Mercury (g)
1	White/Orange	0.395	0.357	White/Yellow	0.395	0.388
2	White/Green	0.531	0.480	White/Blue	0.531	0.522
3	White/Gray	0.790	0.714	White/Black	0.790	0.776
Alloy/Hg ratio: 1/0.90 (47.5% Hg)			Alloy/Hg ratio: 1/0.98 (49.6% Hg)			

Instructions for Use

Powder: mix the alloy with mercury according to the ratio showed in the table above. The amalgam can be made initially softer or harder by slightly modifying the mixing ratio.

Capsule: choose the spill size according to the cavity size to be filled.

Activation of the capsules: with the capsule inverted, softly press the plunger or piston against a firm surface until the plunger has penetrated totally. This is very important in order to expel all of the mercury into the capsule (see the figure).

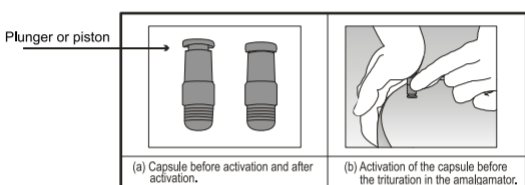

Activation can also be made between two fingers.

Trituration: place the capsule in the amalgamator at a setting that allows you to obtain a shiny and plastic amalgam. Extra-fast amalgamators or settings are not recommended. Some trituration times for specific amalgamators are shown in following table.

Amalgamator	Minimum trituration time (s)
Dentomax Compact	12
Ghimas Super Digital	Not recommended
Medimix 03 (med. speed)	14
Promix model 400 (turtle)	18
Promix model 400 (rabbit)	14
Silamat	11
Ultramat 2	13
WIG-L-BUG model LP-60 (LO)	32
WIG-L-BUG model LP-60 (ME)	14
WIG-L-BUG model LP-60 (HI)	Not recommended
YG-SC	25

It may be necessary to adjust the trituration time and speed as amalgamators differ in specifications (machine type, age, line voltage) and dental professionals differ in their preferences. Avoid under-trituration (insufficient time and/or speed) or over-trituration (excessive time and/or speed), because this can detrimentally affect the characteristics of the product. An amalgam with adequate consistency is demonstrated by both its shiny surface and its plasticity.

Condensation: immediately after trituration, remove the capsule from the amalgamator and tap the base (opposite end to the plunger) several times on a firm surface to ensure that all of the amalgam is located in the base. Separate the base from the capsule and begin to condense as soon as trituration is completed, building the filling using small increments. It is not necessary to express the amalgam. Remove any mercury-rich amalgam from the surface that may develop during condensing. The condensing can be made with conventional techniques. Ultrasonic condensing is not recommended. Apply enough pressure to ensure good adaptation and avoid porosity inside the restoration. Build the restoration with additional amalgam until the cavity is slightly over filled prior to carving and burnishing.

Carving and burnishing: carving may begin immediately after completion of condensing. Burnishing improves the adaptation of the marginal edges and the surface smoothness of the restoration.

Polishing: polishing enhances the surface qualities of the amalgam because the mercury-rich layers are removed and a smooth surface is obtained. The corrosion resistance is improved as well, and the accumulation of bacterial plaque is avoided. Avoid over heating by ensuring adequate water cooling.

Warning and precautions: do not use the product in patients with known allergies or hypersensitivity to amalgam or its components. The professional must evaluate under clinical criteria the use of the product in following cases: pregnant or nursing women, people with impaired kidney function, close contact with other metal restorations different from amalgam, patients having many amalgam restorations, or children younger than 6 years. However according to available scientific knowledge, the use of amalgam as a restorative material is not associated with any adverse health effects.

This product is only for dental use. Keep out of the reach of children. Observe the local regulations for disposal of amalgam scrap and contaminated material. See the material safety data sheet (MSDS) for more information in our web site www.newstetic.com.

Mercury presents a health hazard if incorrectly handled. Spillages of mercury should be removed immediately, including from places which are difficult to access. Use a plastic syringe without a needle, dropper or similar to draw it up. Smaller quantities must be removed. Avoid inhalation of the vapor. Work in a ventilated place with non-textile decontaminable coatings. Store in a clean and dry place, at a temperature no higher than 25 ° C
Health Certificate: INVIMA2020 DM-0005280-R1



R_{only} ISO 24234
Single Use Only

Manufactured by:

New Stetic S.A.

Carrera 53 No. 50-09 Guarne, Antioquia, Colombia, S.A.
infocolombia@newstetic.com - www.newstetic.com